

Phase 1 Traffic Management start date: Monday 05/09/2022 finish Monday 15/09/2022

PHASE 1			
START DATE	END DATE	DURATION (DAYS)	TIME (HOURS)

- KEYS:**
- LINE OF CONES
 - WORK AREA
 - SIGN LOCATION AND ORIENTATION
 - HERAS FENCING
 - WATER BARRIERS
 - PUSH BUTTON
 - TEMPORARY LIGHTS
 - PEDESTRIAN ROUTE
 - TEMPORARY RAMP
 - EAST-BOUND TRAFFIC DIVERSION
 - WEST-BOUND TRAFFIC DIVERSION
 - LOCAL TRAFFIC DIVERSION

450X600 SOCIAL DISTANCING SIGN - LOCATIONS TO BE DETERMINED BY SCHEME ENGINEER

NOTES:

- ALL DIMENSIONS ARE IN METRES UNLESS OTHERWISE STATED.
- ALL TRAFFIC SIGNS TO BE IN ACCORDANCE WITH THE TRAFFIC SIGNS REGULATIONS AND GENERAL DIRECTIONS AND CHAPTER 8 OF THE TRAFFIC SIGNS MANUAL.
- THE PROPOSALS SHOWN ARE NOT NECESSARILY A COMPLETE ILLUSTRATION OF THE TRAFFIC MANAGEMENT MEASURES REQUIRED TO FULLY COMPLY WITH CHAPTER 8 OF TRAFFIC SIGNS MANUAL.
- 45° TAPERS HAVE 1.5M SPACING, NO RELAXATIONS
- N MOTORWAYS AND NSL AP DUALS WITH HARD SHOULDERS, 1M CONES WILL BE REQUIRED FOR BOTH STANDARD AND RELAXATION WORKS FOR LEAD TAPERS AND THE FACING WALL OF LANE CHANGES.

C1	FIRST ISSUE	MP	MP	CJ	RC	25/07/2022
REV	DETAILS	DRWN	DES	CHKD	APPD	DATE

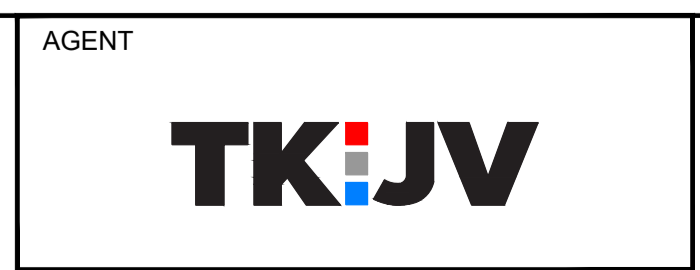

PROJECT NAME
A127 GALLOWES CORNER

DRAWING TITLE
SHEET 001 OF 004

REFERENCE

SUITABILITY: D3

SCALE: 1:200
DIMENSIONS: m
COPYRIGHT ©TKJV
ORIG DWG SIZE: A1

DRAWING STATUS

WORK IN PROGRESS
PRELIMINARY
CONSTRUCTION
AS-BUILT

DRAWING NUMBER	PROJECT	ORIGINATOR	VOLUME	TKJV PROJECT REFERENCE
XXXX	CFR11	TKJV	TTM	STIC
LOCATION	TYPE	ROLE	NUMBER	REVISION
			0101001	C1

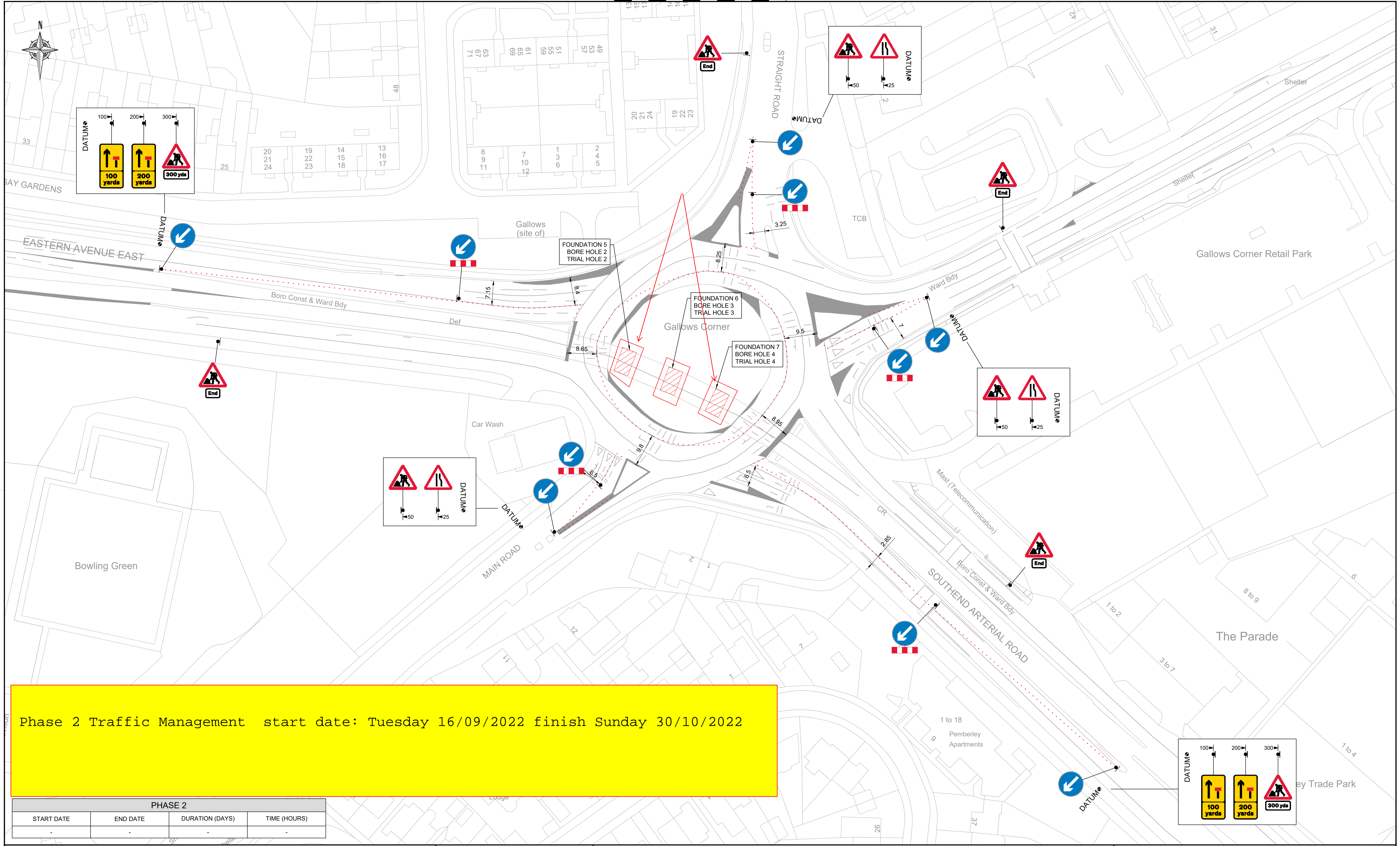

Phase 2 Traffic Management start date: Tuesday 16/09/2022 finish Sunday 30/10/2022

PHASE 2			
START DATE	END DATE	DURATION (DAYS)	TIME (HOURS)

- KEYS:**
- LINE OF CONES
 - WORK AREA
 - SIGN LOCATION AND ORIENTATION
 - HERAS FENCING
 - WATER BARRIERS
 - PUSH BUTTON
 - TEMPORARY LIGHTS
 - PEDESTRIAN ROUTE
 - TEMPORARY RAMP
 - EAST-BOUND TRAFFIC DIVERSION
 - WEST-BOUND TRAFFIC DIVERSION
 - LOCAL TRAFFIC DIVERSION

450X600 SOCIAL DISTANCING SIGN - LOCATIONS TO BE DETERMINED BY SCHEME ENGINEER

NOTES:

- ALL DIMENSIONS ARE IN METRES UNLESS OTHERWISE STATED.
- ALL TRAFFIC SIGNS TO BE IN ACCORDANCE WITH THE TRAFFIC SIGNS REGULATIONS AND GENERAL DIRECTIONS AND CHAPTER 8 OF THE TRAFFIC SIGNS MANUAL.
- THE PROPOSALS SHOWN ARE NOT NECESSARILY A COMPLETE ILLUSTRATION OF THE TRAFFIC MANAGEMENT MEASURES REQUIRED TO FULLY COMPLY WITH CHAPTER 8 OF TRAFFIC SIGNS MANUAL.
- 45° TAPERS HAVE 1.5M SPACING, NO RELAXATIONS
- N MOTORWAYS AND NSL AP DUALS WITH HARD SHOULDERS, 1M CONES WILL BE REQUIRED FOR BOTH STANDARD AND RELAXATION WORKS FOR LEAD TAPERS AND THE FACING WALL OF LANE CHANGES.

C1	FIRST ISSUE	MP	MP	CJ	RC	25/07/2022
REV	DETAILS	DRWN	DES	CHKD	APPD	DATE

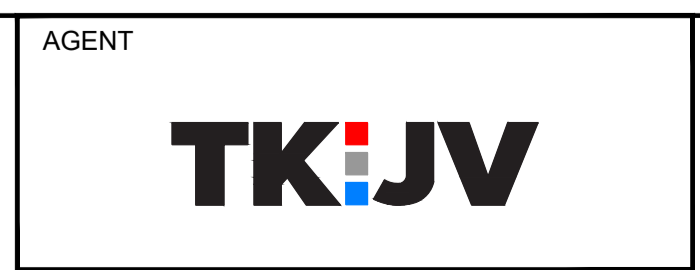

PROJECT NAME
A127 GALLOW'S CORNER

DRAWING TITLE
SHEET 002 OF 004

REFERENCE

SUITABILITY: D3

SCALE:	1:200	DRAWING STATUS
DIMENSIONS:	m	WORK IN PROGRESS
COPYRIGHT	©TKJV	PRELIMINARY
ORIG DWG SIZE:	A1	CONSTRUCTION
		AS-BUILT

DRAWING NUMBER	PROJECT	ORIGINATOR	VOLUME	TKJV PROJECT REFERENCE
XXXX	CFR11	TKJV	TTM	STIC
LOCATION	TYPE	ROLE	NUMBER	REVISION
			0101002	C1



- KEYS:**
- LINE OF CONES
 - ▨ WORK AREA
 - ⬇ SIGN LOCATION AND ORIENTATION
 - ⊕ HERAS FENCING
 - ▬ WATER BARRIERS
 - 👮 PUSH BUTTON
 - 🚶 PEDESTRIAN ROUTE
 - 🚧 TEMPORARY RAMP
 - EAST-BOUND TRAFFIC DIVERSION
 - WEST-BOUND TRAFFIC DIVERSION
 - LOCAL TRAFFIC DIVERSION

450X600 SOCIAL DISTANCING SIGN - LOCATIONS TO BE DETERMINED BY SCHEME ENGINEER

NOTES:

- ALL DIMENSIONS ARE IN METRES UNLESS OTHERWISE STATED.
- ALL TRAFFIC SIGNS TO BE IN ACCORDANCE WITH THE TRAFFIC SIGNS REGULATIONS AND GENERAL DIRECTIONS AND CHAPTER 8 OF THE TRAFFIC SIGNS MANUAL.
- THE PROPOSALS SHOWN ARE NOT NECESSARILY A COMPLETE ILLUSTRATION OF THE TRAFFIC MANAGEMENT MEASURES REQUIRED TO FULLY COMPLY WITH CHAPTER 8 OF TRAFFIC SIGNS MANUAL.
- 45° TAPERS HAVE 1.5M SPACING, NO RELAXATIONS
- N MOTORWAYS AND NSL AP DUALS WITH HARD SHOULDERS. 1M CONES WILL BE REQUIRED FOR BOTH STANDARD AND RELAXATION WORKS FOR LEAD TAPERS AND THE FACING WALL OF LANE CHANGES.

REV	C1	FIRST ISSUE	MP	MP	CJ	RC	25/07/2022
REV		DETAILS	DRWN	DES	CHKD	APPD	DATE

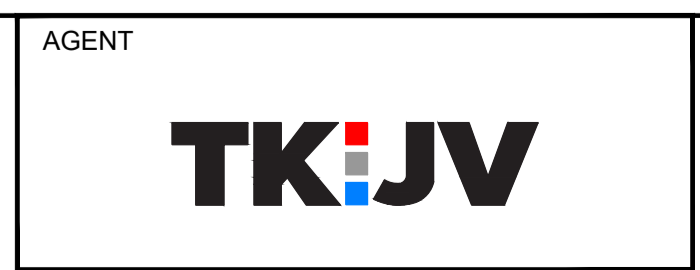

PROJECT NAME
A127 GALLOWES CORNER

DRAWING TITLE
SHEET 003 OF 004

REFERENCE

SUITABILITY: D3

SCALE:	1:200	DRAWING STATUS
DIMENSIONS:	m	WORK IN PROGRESS
COPYRIGHT	©TKJV	PRELIMINARY
ORIG DWG SIZE:	A1	CONSTRUCTION <input checked="" type="checkbox"/>
		AS-BUILT

DRAWING NUMBER	PROJECT	ORIGINATOR	VOLUME	TKJV PROJECT REFERENCE
XXXX	- TKJV	- TTM		STIC
CFR11	- PD	- CH	- 0101003	REVISION
LOCATION	TYPE	ROLE	NUMBER	C1



KEYS:

LINE OF CONES	PUSH BUTTON	WEST-BOUND TRAFFIC DIVERSION
WORK AREA	TEMPORARY LIGHTS	LOCAL TRAFFIC DIVERSION
SIGN LOCATION AND ORIENTATION	PEDESTRIAN ROUTE	
HERAS FENCING	TEMPORARY RAMP	
WATER BARRIERS	EAST-BOUND TRAFFIC DIVERSION	

450X600 SOCIAL DISTANCING SIGN - LOCATIONS TO BE DETERMINED BY SCHEME ENGINEER

NOTES:

1. ALL DIMENSIONS ARE IN METRES UNLESS OTHERWISE STATED.
2. ALL TRAFFIC SIGNS TO BE IN ACCORDANCE WITH THE TRAFFIC SIGNS REGULATIONS AND GENERAL DIRECTIONS AND CHAPTER 8 OF THE TRAFFIC SIGNS MANUAL.
3. THE PROPOSALS SHOWN ARE NOT NECESSARILY A COMPLETE ILLUSTRATION OF THE TRAFFIC MANAGEMENT MEASURES REQUIRED TO FULLY COMPLY WITH CHAPTER 8 OF TRAFFIC SIGNS MANUAL.
4. 45° TAPERS HAVE 1.5M SPACING, NO RELAXATIONS
5. N MOTORWAYS AND NSL AP DUALS WITH HARD SHOULDERS. 1M CONES WILL BE REQUIRED FOR BOTH STANDARD AND RELAXATION WORKS FOR LEAD TAPERS AND THE FACING WALL OF LANE CHANGES.

© CROWN COPYRIGHT AND DATABASE RIGHTS (2022) OS 100030649

CLIENT

AGENT

PROJECT NAME
A127 GALLOWES CORNER

DRAWING TITLE
SHEET 004 OF 004

REFERENCE

SUITABILITY: **D3**

SCALE:	1:200
DIMENSIONS:	m
COPYRIGHT	©TKJV
ORIG DWG SIZE:	A1

FOR CONTRACTOR DESIGN

DRAWING STATUS		DRAWING NUMBER				TKJV PROJECT REFERENCE
WORK IN PROGRESS		PROJECT	ORIGINATOR	VOLUME		
PRELIMINARY		XXXX	TKJV	TTM		
CONSTRUCTION	<input checked="" type="checkbox"/>	CFR11	PD - CH	0101004		
AS-BUILT		LOCATION	TYPE	ROLE	NUMBER	REVISION
						C1

REV	DETAILS	DRWN	DES	CHKD	APPD	DATE
C1	FIRST ISSUE	MP	MP	CJ	RC	25/07/2022